



BUILDING
UNITY
Capital Campaign

Our VISION

That all God's children are
'thoroughly equipped for every good work'.

- 2 Tim 3:17

Building Unity

A campaign to strengthen our community, expand our facilities,
and equip students for generations to come.

Bible Based Education

According to the norms of God's Word

Nurtures

care for, nourish; a learning process of
encouraging, risking, leading and training

Knowledge

includes information, attitudes, and abilities

Maturity

includes personality integration, independence,
self-esteem, discipline

Commitment

discipleship, willingness to serve, trust and
obedience

His people

All followers of Jesus

Our MISSION

**Our mission is to assist parents
by providing each student a Bible
based elementary education in a
supportive Christian classroom
community that nurtures growth
in knowledge, maturity and
commitment to God for sharing in
the life and work of His people in
the world.**



Our ROOTS

- 1952
The CCS West 5th Campus was established
- 2019
The West 5th Campus was at capacity
- 2020
God provided Unity Campus, allowing expansion
- 2020
CCS launched the Building Unity Capital Campaign
- 2021
The Unity Campus was established
- 2022
We celebrated 70 years of God's Faithfulness
- 2025
470 Total Students Currently Enrolled

Our HISTORY

Calvin Christian School was established in 1952 as a Bible-centered school guided from a Reformed Christian perspective that believes a relationship with God is the most important relationship in human life and it affects, directly and indirectly, all other activities and dimensions.

Rooted in a Christ-centered foundation, we offer excellent, high-quality academics within a safe and nurturing environment. From the classroom to the playground, from the music room to the athletic field, students are encouraged to grow in Christ-like character and to strive for excellence in every area of life.

GROWING IN GOD'S FAITHFULNESS

At Calvin, education is more than academic achievement. It is a calling to shape the hearts, minds, and lives of students to reflect God's purpose for them. This commitment is embodied in our core values:

- ***We are a Community of Growth and Learning, seeking to pursue Godly wisdom together.***
- ***We are a Community of Faith, walking by faith and anchored in the hope of Christ.***
- ***We are a Community of Heart, dedicated to cultivating Christ-like character in all we do.***
- ***We are a Community Living Out Our Mission, working together to serve God's purpose in the world.***

Our vibrant community, composed of dedicated teachers, engaged parents, and committed supporters, equips students to flourish both in faith and in life. We invite you to partner with us in this mission, ensuring that future generations continue to grow in knowledge, wisdom, and love for Christ.

In 2019 the West 5th campus was at capacity and new families were not able to enrol their children at the school. Near the end of that year, the Lord provided the Unity campus and Calvin's membership voted overwhelmingly in favour of purchasing this property, allowing the school to expand. In 2020 Calvin Christian School launched the Building Unity Capital Campaign to facilitate new

students; however, the COVID pandemic stalled the campaign and resulted in dramatic increases in construction costs.

In the 2024/2025 school year, Calvin Christian School developed a comprehensive Strategic Plan to guide our mission and growth in the years ahead. One of its central themes is to be Future Ready, preparing not only our students for the future, but also ensuring that our school is equipped to meet the growing demand for Christ-centered education. As more families seek a Christian learning environment rooted in faith, excellence, and hospitality, we are committed to being a place that can welcome and serve them well. In response to this need, our objective is to see Phase 1 of the Building Unity project successfully completed which will lay the foundation for long-term growth and ensure we can faithfully serve the next generation.

Since our founding in 1952, Calvin Christian School has remained dedicated to laying a strong spiritual and academic foundation in the lives of young students. Over the decades, we have had the privilege of nurturing nearly **3000** students during their formative years, equipping them to transition confidently into high school and beyond. These students carry with them the values, faith, and character shaped here, impacting their homes, churches, and communities as they continue to grow into who God has created them to be.

We are blessed to be a **one** society, **two** campus school
with **470** students from **245** families representing **58** churches.





Where We Are **TODAY**

We are grateful for God's provision of both the West 5th and Unity Road campuses. Together they help us meet the needs of our growing student body and remain faithful to our mission.

Yet, the Unity Road campus now requires significant repairs and expansion to continue serving our students well.

KEY IMPROVEMENTS WE HOPE TO MAKE:

- **A Renewed Staff Lounge and Workroom**
A refreshed space where teachers and staff can collaborate, recharge, and prepare to serve students well.
- **Dedicated Student Support Services**
Purpose-built offices and breakout rooms designed to provide individualized care and learning support.
- **Modernized Washrooms**
Bright, accessible, and family-friendly facilities that meet the needs of our growing community.
- **The edVenture Studio**
A flexible, multipurpose space with direct outdoor access, fostering hands-on learning experiences both inside and outside the classroom.
- **Three New Primary/Junior Classrooms**
Spacious and welcoming environments designed to nurture curiosity and academic growth in Grades 1–6.
- **Two New Kindergarten Classrooms**
Purposeful, child-centered spaces that inspire discovery, play, and a strong foundation for lifelong learning.



Why Your **PARTNERSHIP MATTERS**

Calvin Christian School operates entirely on tuition and donations.

We need the Lord to provide *\$1000* per student in donations every year just to balance the budget!

The faithful partnership of our entire CCS community ensures every family has access to Christ-centered education, regardless of financial circumstances.



Big plans for UNITY CAMPUS

PHASE ONE WILL CONSIST OF SEVERAL ADDITIONS TO THE ORIGINAL BUILDING:

- 1 Expanded Classrooms**
Room for 12 bright, modern classrooms that support growing enrollment and engaging learning.
- 2 The edVenture Studio**
A flexible, multipurpose space with direct outdoor access, fostering hands-on learning experiences both inside and outside the classroom.
- 3 Dedicated Learning Spaces**
Purpose-built areas for music, resource support, and small group instruction.
- 4 Improved Accessibility**
A welcoming, inclusive environment designed to meet the needs of every student.
- 5 Safe & Secure Facilities**
Upgrades that prioritize student safety and ensure sustainability for years to come.
- 6 Enhanced Parking & Traffic Flow**
73 new parking spaces and improved bus circulation for smoother arrivals and departures.
- 7 Revitalized Outdoor Spaces**
New trees, canopy seating, and thoughtfully designed areas for outdoor learning, play, and community connection.
- 8 Future Growth in Mind**
Plans for potential studio additions to expand opportunities as needs arise.



Why This MATTERS

These renovations are not about buildings alone - they are about children. Every square foot of expanded space means more room for students to learn, play, worship, and grow in Christ-like character. A renewed Unity Campus strengthens our ability to equip students today and for generations to come.

"We're not just building a school - we're building a community of faith, learning, and unity."

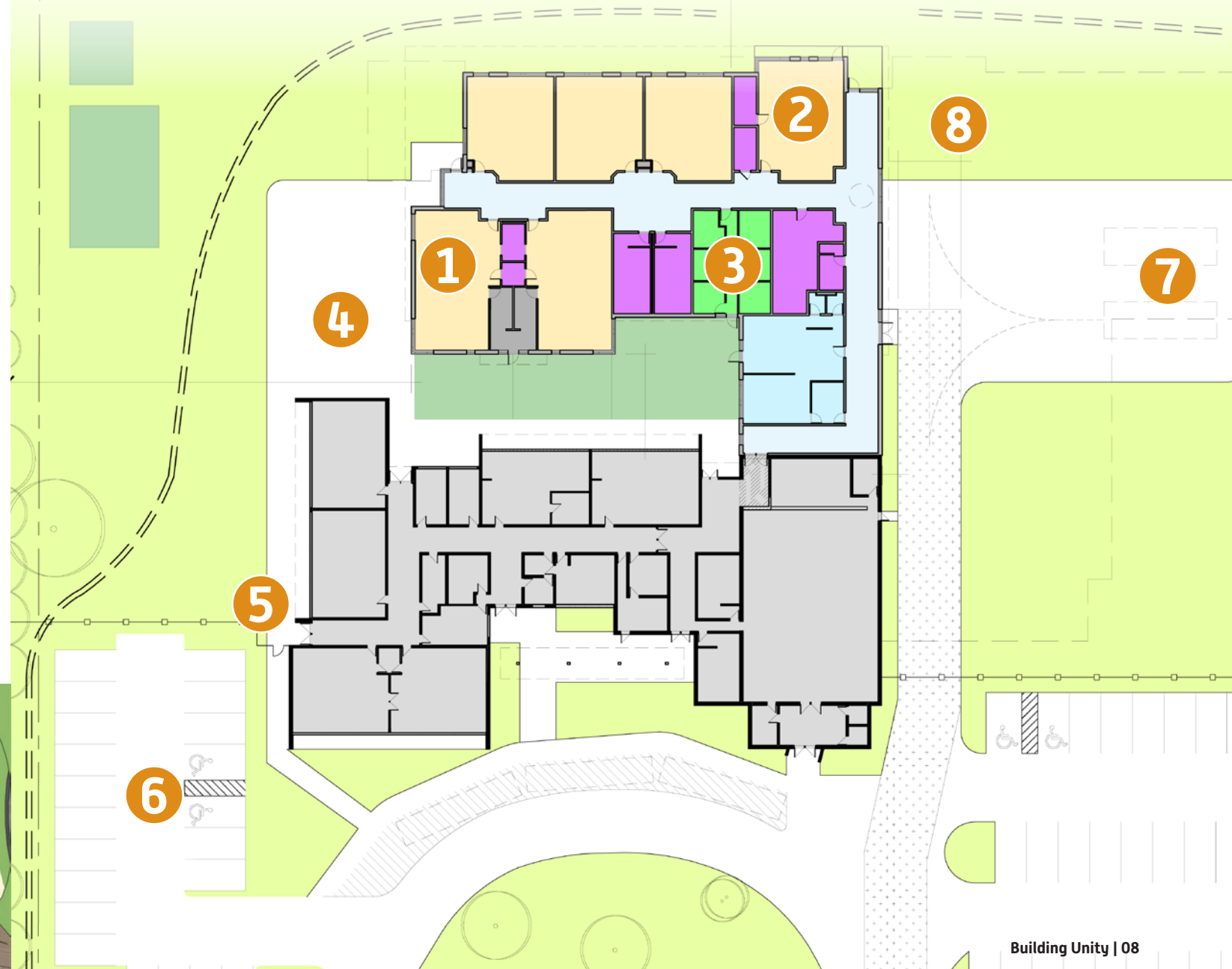

WHAT GOD HAS PROVIDED

Celebrating God's Faithfulness

From the very beginning, Calvin Christian School has relied on God's faithfulness and the generosity of His people. Time and again, the Lord has provided - and this campaign is no exception.



Already Pledged

\$2.8M



God opened the door for us to purchase Unity Campus.



\$2.8 million has already been pledged and donated.



An archeological study was completed and passed.



A \$1 million dollar 3 phase power upgrade from highway 6 may be provided at no cost.



Approximately \$40k in development charges are being waived by Haldimand County.



Haldimand County removed the requirement for Parkland Dedication resulting in added savings.

What's Left TO BE RAISED

The cost for this project changes every year we delay. As the Management Team has done their due diligence in working through the cost estimates, we are praying that the Lord will provide **\$5 million** by the end of 2025, allowing us to move forward with confidence, see shovels in the ground, and begin turning vision into reality. To complete the project, we will eventually require an estimated **\$3.3 million** to be raised or financed for a total of **\$8.3 million**, which includes paying off the initial **\$1,750,000** purchase of the property.

This campaign can't succeed on the generosity of a few, but on the shared commitment of all of us working together. Equal Sacrifice. Various Amounts. We are asking the entire CCS community to participate. The level of sacrifice should be the same for everyone. What will the Lord ask you to give? What will each of us have to give up to honor Him? How will all of us participate? The amounts will vary but the sacrifice will be the same.

HOW YOU CAN PARTICIPATE



Pray

Seek God's face and ask Him what you should pledge over the next two years. We ask that families pray together, asking God to lead your family, and to provide money in unexpected and unusual ways.



Listen

Make space in your life to hear from God. Teach your children to listen to the Spirit's leading.



Obey

Give what the Lord has laid on your heart. Fill out a pledge card online or in person. Continue to pray for His provision. Let Him surprise you with His generosity.



Connect

Prayerfully consider if there are people in your circle of influence the Lord may direct you to introduce to the Building Unity Campaign.

"Now to Him who is able to do immeasurably more than all we ask or imagine..."

Ephesians 3:20

Together, through equal sacrifice and shared obedience, we will see God's provision and ensure future generations are equipped to shine.

HOW TO GIVE

Every gift to the Building Unity Capital Campaign will directly impact the ministry of Calvin Christian School, both now and for generations to come. Each gift is gratefully received and is tax receiptable at year end.

YOU HAVE SEVERAL GIVING OPTIONS:

Gifts of Cash or Cheque

Cash gifts provide immediate resources to the campaign. Please indicate in a sealed envelope that the cash gift is for the Building Unity Campaign and bring it to either campus office.

Cheques should be made out to Calvin Christian School. Please indicate the amount that is intended for the Building Unity Campaign in the memo section.

E-Transfer

If you prefer to e-transfer, please send your amount to payment@ccshamilton.ca. Please indicate in the notes section that this is for the Building Unity Campaign.

Automatic Withdrawal

You can sign up for an automatic withdrawal for a specified amount, which is taken out monthly. Contact the CCS office for more information.

“Each of you should give what you have decided in your heart to give, not reluctantly or under compulsion, for God loves a cheerful giver.”

2 Corinthians 9:7

Give online with your Credit Card

You can contribute using your credit card at www.ccshamilton.ca and click the ‘Donations’ button. Note that there is a service fee of 2.5% that goes to the company providing this service.

Gifts of Securities

Gifts of securities can be advantageous for some donors. Please talk to your financial advisor. Inquire at the CCS office for more information.



If you have questions about any these ways of giving, or need help setting up your preferred choice, please connect with Yvonne Weaver, (Finance Manager) at yweaver@ccshamilton.ca

Pledged Giving

A pledge is a financial commitment to the Building Unity Campaign that God has led you to prayerfully give. Pledges can be made as a one-time gift or can be set up over the next two years, in varying amounts, until the sum has been received. Pledges can be modified if needed. Pledging toward the campaign lets the Campaign leadership know how much the Lord has provided and how much we are praying for.

Eg. The Smith family has decided to pledge \$6000 over a 24 month period that they will contribute in amounts of \$250 a month by setting up pre-authorized withdrawal

BUILDING UNITY
Capital Campaign

Campaign for Calvin Christian School Unity Campus Expansion.

In support of Building Unity:
I/We agree to contribute the sum of \$ _____ to the campaign.
I/We expect to make this gift in cash or securities over the period of _____ (month/year).
_____ years, beginning _____

I/We plan to make installments:
☐ Annually ☐ Semi-Annually ☐ Quarterly ☐ Monthly

☐ Please contact me about fulfilling my campaign commitment to Building Unity preauthorized giving.

Please send pledge reminders and receipts to this address:

Name(s) _____
Address _____ City _____ Postal code _____
Apartment # _____
Province _____ Work _____
Telephone: Home _____ Date _____
Signature _____

Cheques should be made payable to Calvin Christian School and designated for "Building Unity" or "Capital Campaign."
Talk to your financial advisor about a gift of securities.
Inquire at the CCS office for more information.

Calvin Christian School
32 Unity Side Road,
Caledonia, ON N3W 1M3
email: campaign@ccshamilton.ca

All gifts to the Campaign are tax deductible to the full extent provided by law.
Charitable business registration number: 118825900 RR0001

GOD IS AT WORK IN CHRISTIAN EDUCATION

and Calvin Christian School is no exception.

Across southern Ontario, and especially in the greater Hamilton area, interest in solidly biblical, Christ-centered education is growing rapidly. Many Christian parents and guardians are seeking an education for their children that aligns with their faith. Calvin Christian School has a long history of serving Christian families with excellent, Christ-centered education, and as both campuses fill to capacity, the need for more space is becoming increasingly urgent.

The area around the Unity campus is especially vibrant, with new communities taking shape and existing neighborhoods continuing to grow. Christian families in these areas are showing strong interest in what Calvin Christian School has to offer. As a result, the current facility on Unity Road is no longer sufficient and expansion is needed to meet the increasing demand.

What an incredible opportunity and blessing: to be in need of a larger school! Imagine how many more children could be nurtured in their faith, grounded in God's Word, and prepared to be lights in the world if we step forward in faith and grow. We dare not let this moment pass us by.

Now is the time to build, to grow, and to watch what God will do.

Principal, *Michael Noot*
Unity Site Principal, *Amanda Briemer*





Calvin Christian School

547 West 5th Street,
Hamilton, Ontario, L9C 3P7
(905)-388-2645

32 Unity Side Road
Caledonia, Ontario N3W 1M3
(289)-757-9507



ccshamilton.ca

office@ccshamilton.ca